

# Pentamix™ Lite

Automatic Mixing Unit

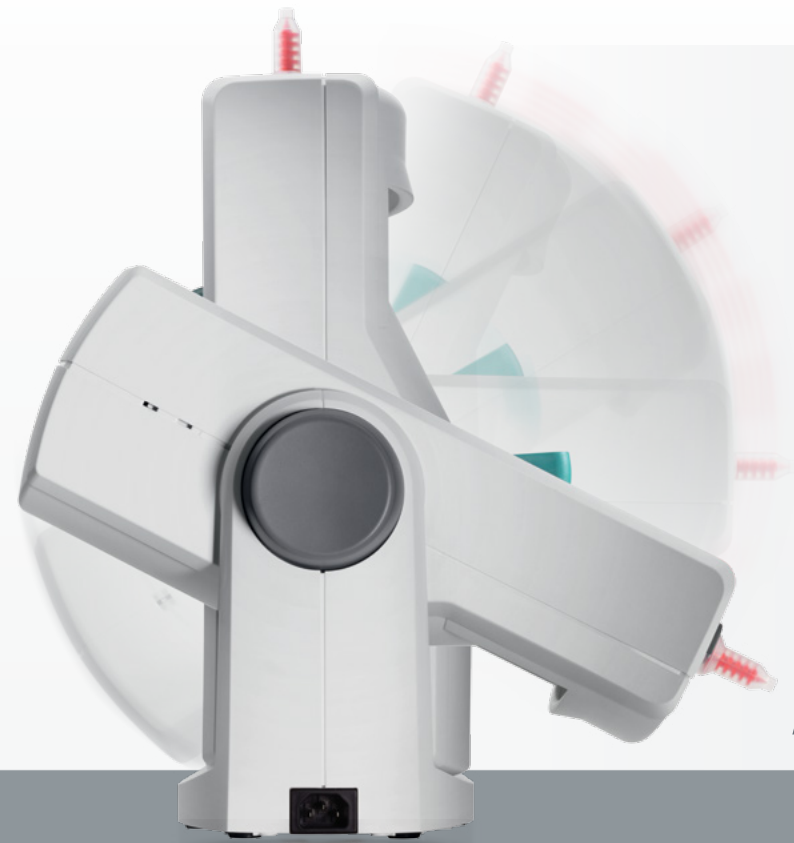

**START**  
**A**  **TOMIXING**  
and simplify your life.

**3M** ESPE

# Pentamix™ Lite

## Automatic Mixing Unit

Bring the control and precision of automixing to your practice with 3M ESPE's **NEW** affordable and portable mixer.

- **Easily carry from operator to operator** with the lightest device on the market
- **Homogeneous and void-free** mixing results of reproducible quality.
- **Fast, time-saving** procedure and push-button activation.
- **Economical** and exact dispensing of the amount of material needed.
- **Hygienic** direct filling of tray and syringe without the risk of cross-contamination.
- **More efficient workflow** for higher productivity.

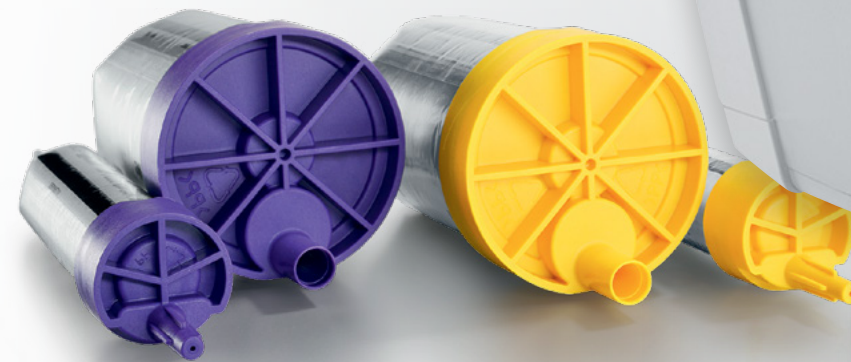

Menu

# 3M ESPE's **ENTRY MODEL** to the world of **AUTOMATIC MIXING**

With its unique swiveling design, the Pentamix™ Lite Automatic Mixing Unit requires a minimum of space in the upright standby position and it can be stowed in a space-saving way.

Thanks to its low weight and its ergonomic hand grip, the device can also easily be carried from one operator to another — if desired. Just plug in, switch on and start mixing!

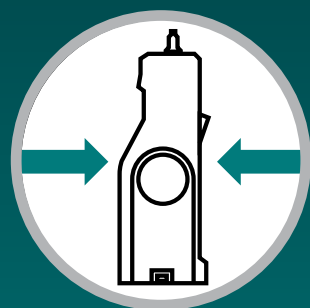

## **COMPACT** design

Saves valuable space in the upright standby position.

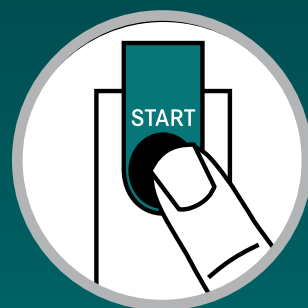

## **CONVENIENT & CLEAN** operation

Press the green start button and start filling the tray or syringe directly from the device.

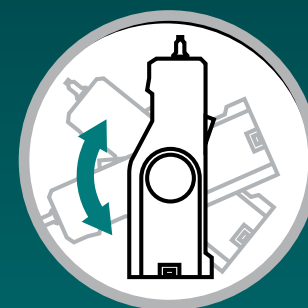

## **EASY** to get started

Fast and intuitive set-up – just swivel in the working position.

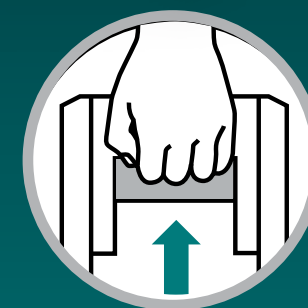

## **PORTABLE** design

Easy to carry from operator to operator thanks to light weight and integrated handgrip.



# Fast and intuitive set-up **AND USE**

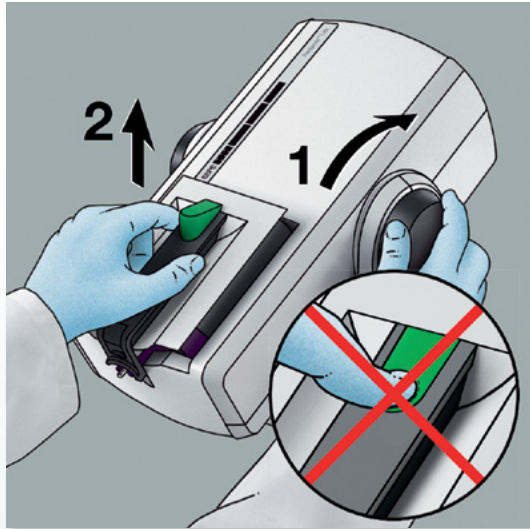

1. Remove the cartridge.

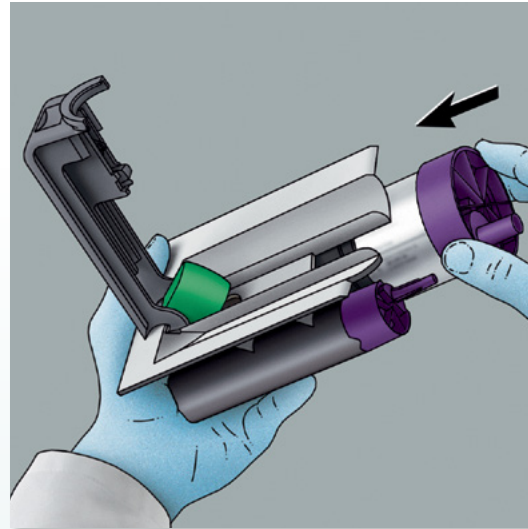

2. Insert Penta™ Foil Bag with the 3M ESPE impression material of your choice into the cartridge.

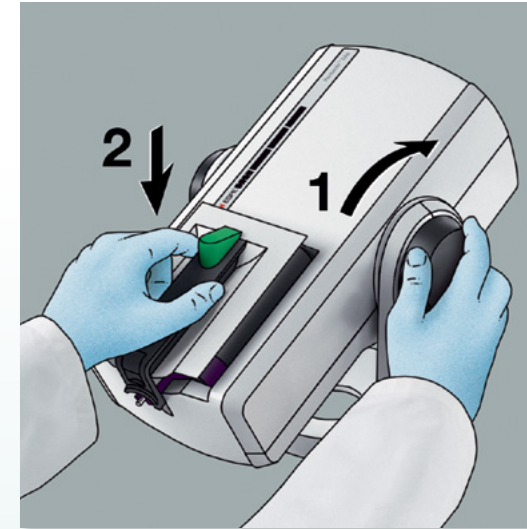

3. Insert the cartridge into the Pentamix™ Lite Automatic Mixing Unit.



4. Turn the wheel (piston) forward.

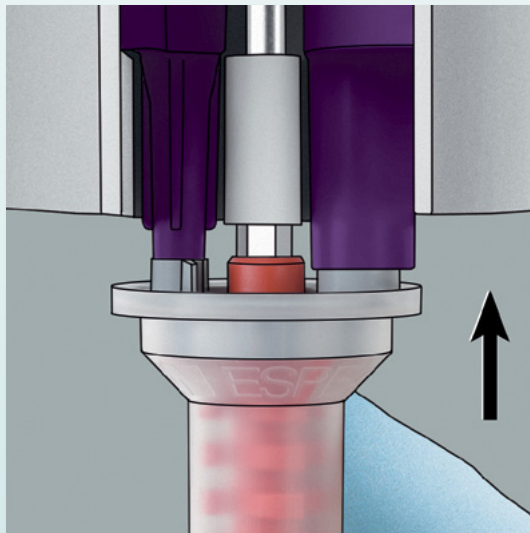

5. Attach a Penta™ Mixing Tip – Red.

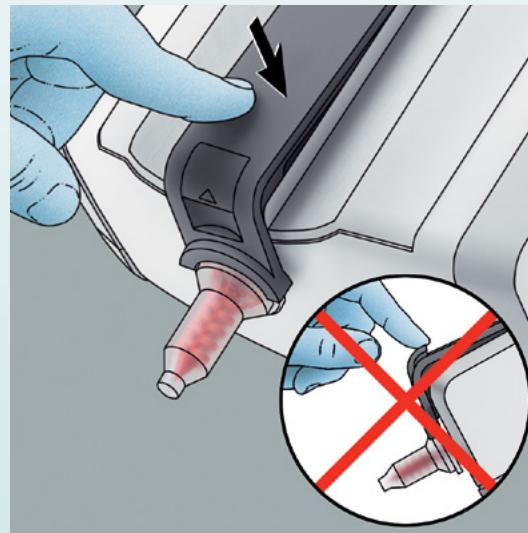

6. Close the latch with an audible click.



7. Press the green start button to fill the impression tray or elastomer syringe.

# ONE mixing device FOR ALL 3M ESPE impression materials

Combine the portable power of the new Pentamix™ Lite Automatic Mixing Unit with excellent Imprint™ 4 VPS and Impregum™ Polyether Impression Materials and you get the perfect mix of precision and accuracy. Suitable for all viscosities — from highly viscous putty to medium-bodied materials.

## Imprint™ 4 VPS Impression Material

Designed for **Speed, Control** and **Precision**.

**SPEED.** Imprint 4 material offers the fastest intra-oral setting time among leading VPS fast-setting impression materials.

**CONTROL.** Imprint 4 materials put you in control with adequate working time — a factor for avoiding problems, and for making good impressions with reliable results.

**PRECISION.** Imprint 4 material is super-hydrophilic, and displaces moisture right from the start in the unset state, which helps prevent detail-disrupting voids.



**GOES PERFECTLY TOGETHER!**  
THE PENTAMIX™ LITE SYSTEM ADDS  
• AFFORDABILITY • CONTROL  
• CONVENIENCE  
TO YOUR IMPRESSION WORK

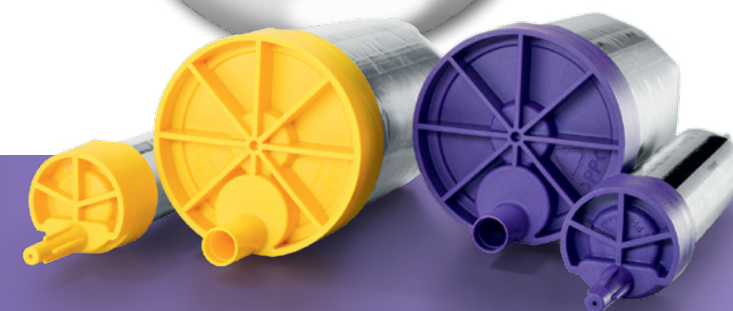









## Impregum™ Polyether Impression Material

With unrivalled product features such as **OUTSTANDING INITIAL HYDROPHILICITY**, **EXCELLENT FLOW** for highest detail reproduction and precision, and **UNIQUE SNAP-SET** behavior, Impregum polyether material helps to achieve high-quality, finely detailed impressions and perfectly fitting restorations, including fewer costly and time-consuming adjustments or reworks.

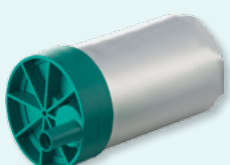

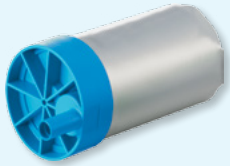
For optimum performance, 3M ESPE only recommends the use of 3M ESPE Penta™ Impression Materials in the Pentamix™ Lite Automatic Mixing Unit. **Non original materials can damage the device!**

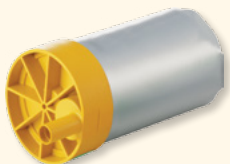
3M ESPE Impression Material		Max. working time from start of mixing (min:sec)	Setting time in mouth (min:sec)	Setting time from start of mixing (min:sec)
POLYETHER IMPRESSION MATERIALS				
 <b>Impregum™ Penta™</b>		1:45*	—	<b>= 6:00</b>
 <b>Impregum™ Penta™ Soft</b>		1:45*	—	<b>= 6:00</b>
VPS IMPRESSION MATERIALS				
 <b>Imprint™ 4 Penta™ Putty</b>		1:30	<b>2:30</b>	—
 <b>Imprint™ 4 Heavy</b>		2:00	<b>2:00</b>	—
 <b>Imprint™ 4 Penta™ Super Quick Heavy</b>		1:15	<b>1:15</b>	—

\* Clinically recommended working time.



### Penta™ Mixing Tip – Red for all Pentamix™ Devices

Always use 3M ESPE Penta Mixing Tips – Red in your Pentamix device to ensure proper mixing and impression results.

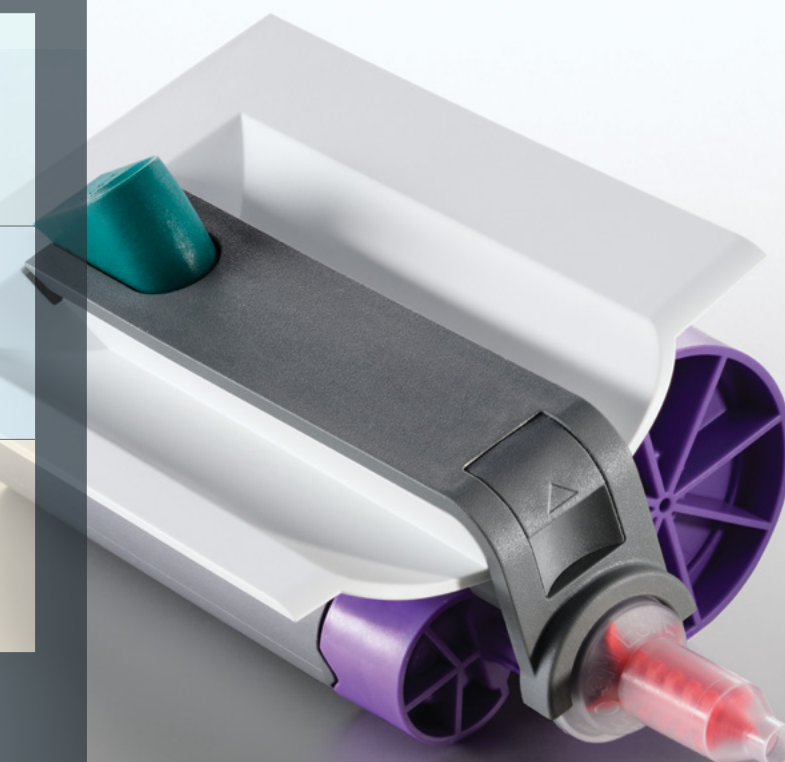

# Ordering Information

## PENTAMIX™ LITE AUTOMATIC MIXING UNIT AND ACCESSORIES

Item No.	Product Information
----------	---------------------

77907	<b>Pentamix™ Lite Automatic Mixing Unit – 120 V/60 Hz</b> Includes: 1 Penta™ Cartridge for Pentamix™ Lite
-------	--

77944	<b>1 Penta™ Cartridge for Pentamix™ Lite</b>
-------	--

77949	<b>Penta™ Mixing Tips – Red</b> Includes: 50 Mixing Tips
-------	---

## IMPREGUM™ SOFT POLYETHER IMPRESSION MATERIAL

**Refills:** Each contains: 2 – 300ml base pastes, 2 – 60ml catalysts

Item No.	Product Information
----------	---------------------

31731	<b>Impregum™ Penta™ Soft Medium Body</b>
-------	--

31741	<b>Impregum™ Penta™ Soft Heavy Body</b>
-------	---

31765	<b>Impregum™ Penta™ Soft Quick Step Medium Body</b>
-------	---

31769	<b>Impregum™ Penta™ Soft Quick Step Heavy Body</b>
-------	--

Item No.	Product Information
----------	---------------------

31746	<b>Impregum™ Penta™ Soft Light Body</b> Contains: 1 – 300ml base pastes, 1 – 60ml catalysts
-------	--

31785	<b>Impregum™ Soft Tray Material</b> Contains: 4 – 50ml cartridges, 10 – polyether tray mixing tips, purple
-------	---

## IMPRINT™ 4 VPS IMPRESSION MATERIAL

**Penta™ Refills — Tray Material:** Each contains: 2 – 300ml base pastes, 2 – 60ml catalysts

Item No.	Product Information
----------	---------------------

71484	<b>Imprint™ 4 Penta™ Heavy</b>
-------	--------------------------------

71485	<b>Imprint™ 4 Penta™ Super Quick Heavy</b>
-------	--

71486	<b>Imprint™ 4 Penta™ Putty</b>
-------	--------------------------------

**Refills — Wash & Tray Materials – Cartridge:** Each contains: 4 – 50ml cartridges, 5 – yellow mixing tips, 5 – green 3M™ ESPE™ Intra-Oral Syringes

Item No.	Product Information
----------	---------------------

71487	<b>Imprint™ 4 Regular</b>
-------	---------------------------

71488	<b>Imprint™ 4 Light</b>
-------	-------------------------

71489	<b>Imprint™ 4 Super Quick Regular</b>
-------	---------------------------------------

71490	<b>Imprint™ 4 Super Quick Light</b>
-------	-------------------------------------

## POSITION™ PENTA™ QUICK VPS IMPRESSION MATERIAL

**Refill:** Contains: 2 – 300ml base pastes, 2 – 60ml catalysts

Item No.	Product Information
----------	---------------------

29063	<b>Position™ Penta™ Quick VPS Alginate Replacement – Refill</b>
-------	---

**Customer Care Center: 1-800-634-2249**  
**[www.3MESPE.com/PentamixLite](http://www.3MESPE.com/PentamixLite)**

**3M ESPE**

**Dental Products**

2510 Conway Avenue  
St. Paul, MN 55144-1000 USA  
1-800-634-2249

**3M Canada**

Post Office Box 5757  
London, Ontario N6A 4T1  
Canada  
1-888-363-3685

3M, ESPE, Impregum, Imprint, Penta and Pentamix are trademarks of 3M or 3M Deutschland GmbH. Used under license in Canada. © 3M 2014. All rights reserved.